

S6064 Series PID Control Ball Valve

S6061Q Series PID Actuator

Introduction

S6064 series ball valve (PID regulating valve) has the features of high reliability and long service life. The valve adopts PTFE graphite ring and dual-EPDM stem seal ring to enhance the sealing of valve, equips unibody rectifier blade to adapt reverse pressure difference. The functions include equal percentage flow, high shutoff force 1.4Mpa, rated working pressure PN16, max. working pressure difference 0.35Mpa, manual actuator short circuit button, and -5 °C to 121 °C working temperature. The valve is applicable to water, steam or 50% water glycol.

Features

1. S6064 series ball valve is widely applicable with overall functions.
 - Build-in unibody rectifier blade
 - Equal percentage flow
 - Adjustable flow ratio
 - Options of different torques
 - Types of switching control, floating control, and continuous regulating
2. S6064 series ball valve is designed for high pressure working.
 - DN15~50 working pressure:2.0Mpa; DN65~150 working pressure:1.6Mpa
 - Max working pressure difference: 0.35Mpa
3. S6064 series ball valve has high adjustable flow ratio for accuracy control in all loading conditions.
 - Build-in unibody high-strength material rectifier blade, without risk of loss
4. S6064 series ball valve adopts stainless steel ball spool and stem for HVAC engineering.
 - Working temperature: -5 to 121 °C
 - Applicable to 50% water glycol
 - Applicable to 100kPa saturated steam
 - Applicable to water system with rust

5. S6064 series ball valve is simply used, different types with connecting fittings could meet all requirements.

Actuator fittings	DN15~DN40	DN50	DN65/80	DN100/125	DN150
Non-Spring Return	S6061Q-04	S6061Q-08	S6061Q-16	S6061Q-24	S6061Q-32

6. S6064 series ball valve adopts high-strength material connecting fittings.
 - High-strength material
 - Suit for high temp or low temp working conditions
 - Resistent to chemical corrosion
 - Reserve required space for piping insulation
 - Matching S6061 actuators with 4 screws fixing for valve and connector.
7. S6064 series ball valve adopts PTFE graphite ring and dual-EPDM stem seal ring to enhance the sealing.
 - Anti-wear function
 - Actuating valve requires low torque
 - Dual-preventing leakage for stem sealing
 - Specific PTFE Teflon stem setting ring
8. S6064 series ball valve has features of small volume, wild option range and wild application area.
 - Varies of air handling units
 - Variable Air Volume, dehumidifying, fan coil unit
 - Single fan unit
 - Air preheating coil unit
 - Roof-top air conditioning unit
 - Boiler system, chiller unit

Valve Specification :

Model	DN	(A-B)Way y KV(m ³ /h)	Bypass KV(m ³ /h)	Angle of Rotation	pressure difference	2-Way (Kg)	3-Wa y (Kg)
S6064-2015A	15	2.5	1.6	0-90 °	0.35Mpa	0.2	0.25
S6064-2015B		4.0	2.5				
S6064-2015C		6.3	4.0				
S6064-2015D		10.0	5.0				
S6064-2020A	20	4.0	2.5			0.35	0.4
S6064-2020B		6.3	4.0				
S6064-2020C		10.0	5.0				
S6064-2025A	25	10.0	6.3			0.55	0.7
S6064-2025B		16.0	8.0				
S6064-2032A	32	16.0	10.0			0.85	1.10
S6064-2032B		25.0	12.5				
S6064-2040A	40	25.0	16.0			1.2	1.4
S6064-2040B		40.0	20.0				
S6064-2050A	50	40.0	25.0			1.95	2.20
S6064-2050B		63.0	31.5				
S6064-2065A	65	63	---			4.5	---
S6064-2080A	80	100	---	6.8	---		
S6064-2100A	100	160	---	8.1	---		
S6064-2125A	125	250	---	12.0	---		
S6064-2150A	150	400	---	18.8	---		

Direction of Flow:

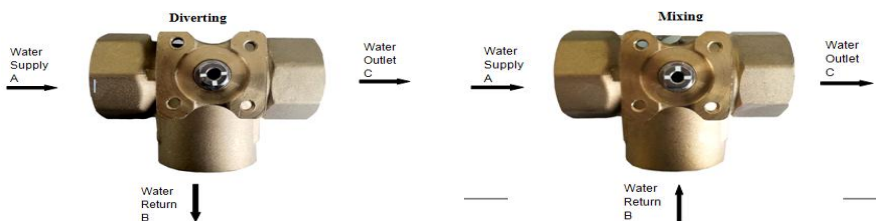

Actuator Specification :

Items	Unit	S6061Q-04	S6061 Q-08	S6061Q-16	S6061Q-24	S6061Q-32	
Torque	Nm	4	8	16	24	32	
DN	mm	DN15~DN40	DN50	DN65、DN80	DN100/DN125	DN150	
Running Time	sec	30~40	30~40	72~88	117~143	A/D: 114~138	
Power Supply	V	24VAC/DC/230VAC/230VAC/110VAC					
Operating Power Consumption	W	D	A	D	A	D	A
		2.5	4.0	3.9(24V) 4.8(230V)	4.0(24V) 4.8(230V)	40 (24V) 55 (230V)	25 (24V) ---
At end stops Power Consumption	W	0.85	3.0	0.4(24V) 1.2(230V)	0.7(24V) 1.0(230V)	03 (24V) 10 (230V)	03 (24V) ---
				Weight	Kg	1.0	1.1
Control Signal		2/3 point	0~10V	Modulating: 0(4)...20mA / 0(2)...10V; On/off: 2/3 point			
Rotation Angle	0~90 ° (Max93 °)						
Auxiliary Switches Rating	3 (1.5) Amp 250V						
Life Cycle	70000 cycles						
Sound Level	45dB(A)						
Protection Standard	IP44 or IP54						
Ambient Temperature	-20~+50°C						
Ambient Humidity	5-95%RH						
Certificate	CE						

Wiring Diagram

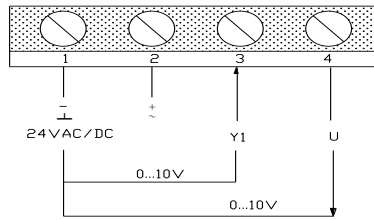

S6061Q-04A/24V

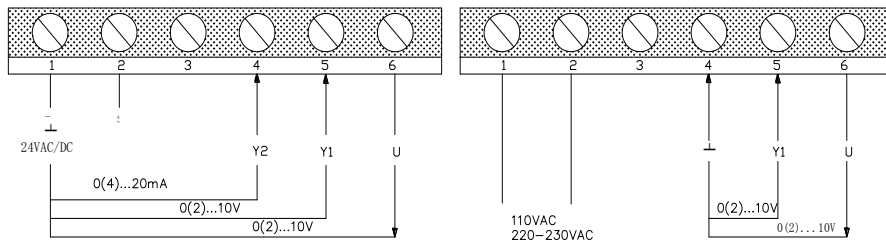

S6061Q-(08~32) A /24V

S6061Q-(08~24)A/230V

S6061Q-(04~32)D

2-point

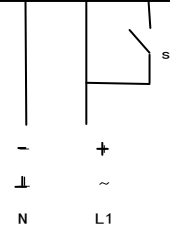

24VAC/DC ± 10%
230VAC ± 10%

3-point

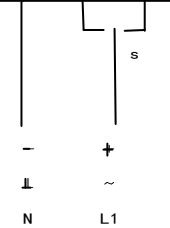
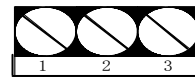

Auxiliary switches

S6061 series damper actuator could have 2 auxiliary switches which set angle in 0-90 ° for output signal. Please set the angle as per the instruction.

Wiring diagram of auxiliary switches



3 (1.5) Amp 220V

The actuator is in 250V

S6061Q-(08-32)A Control Signal and Rotation Direction

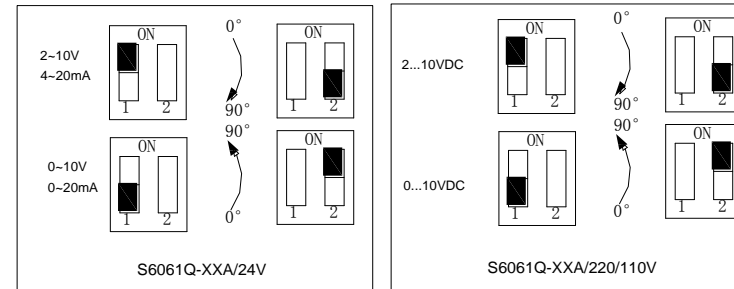

Factory setting

Switch a at 10°
Switch b at 80°

The switching position can be manually changed to any required position by turning the ratchet.

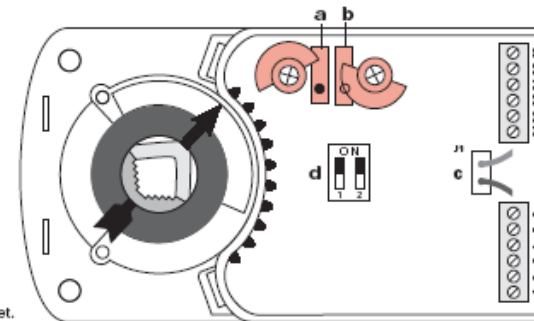

Dimensions: Unit (mm)

Model	G	H(mm)	H1(mm)	L(mm)	S(mm)
S6064-2015	G1/2	184	37.5	60	---
S6064-2020	G3/4	184	44	73	---
S6064-2025	G1	189	47	89	---
S6064-2032	G1-1/4	199	52.5	102.5	---
S6064-2040	G1-1/2	208	57	113	---
S6064-2050	G2	219	62	127.5	---
S6064-3015	G1/2	184	39	60	30.5
S6064-3020	G3/4	184	44	66	32
S6064-3025	G1	189	47	89	46.5
S6064-3032	G1-1/4	199	52.5	98.5	49
S6064-3040	G1-1/2	208	57	106	52
S6064-3050	G2	219	62	123	69

Model	Flange	L(mm)	D(mm)	H(mm)	n-d
S6064-2065	145	97	105	136	4-18
S6064-2080	160	108	125	140	8-18
S6064-2100	175	120	145	104	8-18
S6064-2125	200	145	175	115	8-18
S6064-2150	230	165	205	138	8-18

Note: DN15~50 use BSPP English standard parallel pipe thread connection.

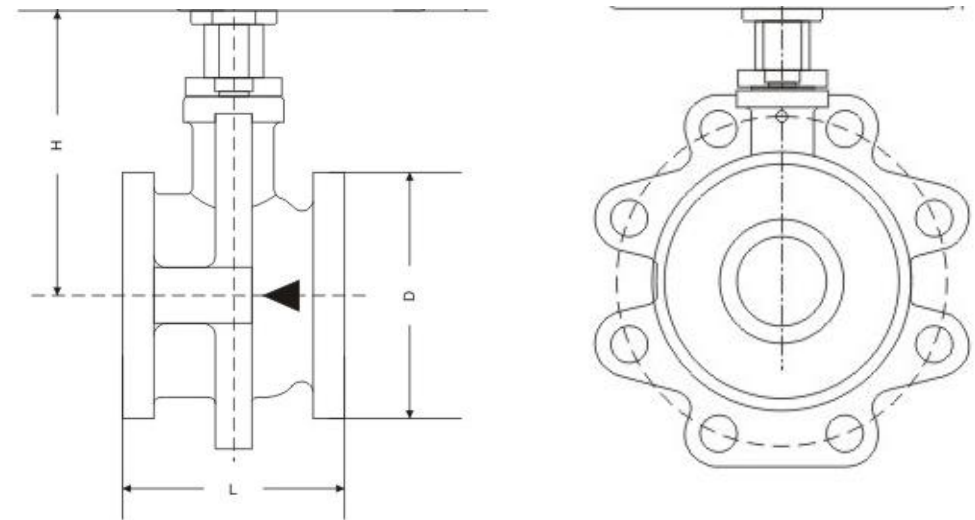

Note: When the valve is opening, do not put your fingers into the valve, so that protect your fingers from the valve when closing.

