

S6054/55 motorised ball valves



S6054/55 series motorised ball valves are available for terminal waterway control. Thermostat control the motorised ball valve actuator, and the actuator motor drive the valve ON/OFF to make the medium flow or disconnected, and the fan coil blow

at the same time to control the temperature automatically.

Features:

Easy installation and cost saving.

Closing tightly and having a great differential pressure.

Water flow smoothly and it won't be blocked by slag. KVS value is much larger than common 2-way valve.

Valve opens safety to guard effectively against water hammer

Product Parameters:

Main material: forging brass body seal PTFE / HNBR
 Actuator torque: 2N.m Nominal pressure: 1.6MPa
 Working medium: water Fluid temperature 5-95°C
 Stem size: 10x10 Valve opening torque: <1N.m

Dimension:

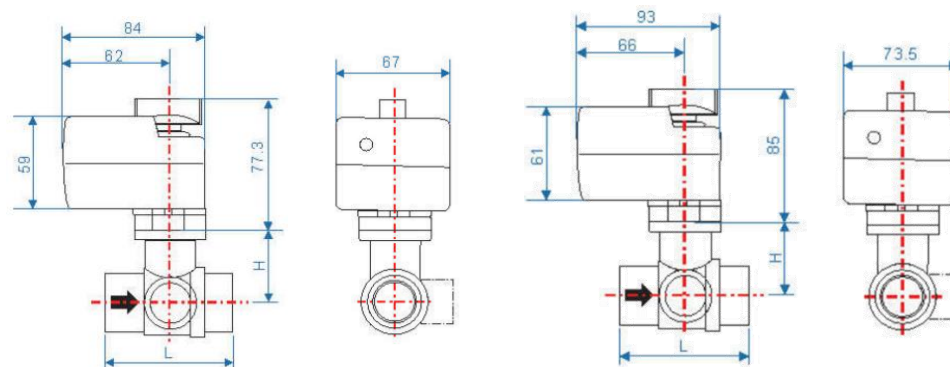

Modulation

On/off

Specification:

Model No.	Valve Type	DN	Thread size	Kv	Size			Maximum difference pressure KPa
					L	H	D	
S6054A/55-2015	2 way	15	G1/2	4.6	60	30	---	600
S6054A/55-2020	2 way	20	G3/4	6.5	67	35	---	600
S6054A/55-2025	2 way	25	G3/4	23.5	89	38	---	500
S6054A/55-3015	3 way	15	G1/2	4.6	60	30	30.5	600
S6054A/55-3020	3 way	20	G3/4	6.5	67	35	32	600
S6054A/55-3025	3 way	25	G1	23.5	89	38	46.5	500
S6054D/55-2015	2 way	15	G1/2	4.6	60	30	---	600
S6054D/55-2020	2 way	20	G3/4	6.5	67	35	---	600
S6054D/55-2025	2 way	25	G3/4	23.5	89	38	---	500
S6054D/55-3015	3 way	15	G1/2	4.6	60	30	30.5	600
S6054D/55-3020	3 way	20	G3/4	6.5	67	35	32	600
S6054D/55-3025	3 way	25	G1	23.5	89	38	46.5	500

