

06 Explosion-Proof Electric Control Ball Valves

This series of actuators is designed for damper control in environments/workplaces with explosive hazardous gases, steam or combustible dust in HVAC, petroleum, petrochemical, metallurgy, ships, power plants, nuclear power plants, pharmaceutical plants, etc. It has obtained China Compulsory Certification (CCC), EU ATEX, IECEx certification, and Russian EAC certification. The electric regulating ball valves are specially designed for the flow control requirements of media such as water, steam, and 50% ethylene glycol in the HVAC system.

► Feature

On/Off and
Modulating Control

DN15~50 working
pressure: 2.0Mpa;
DN65~150 working
pressure: 1.6Mpa

Max working pressure
difference: 0.35Mpa



ExS6061SF/NS

ExS6061Pro

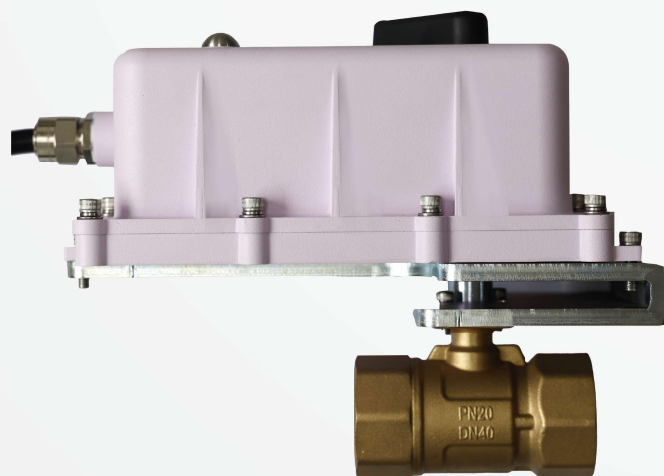

ExS6061

► Order Code

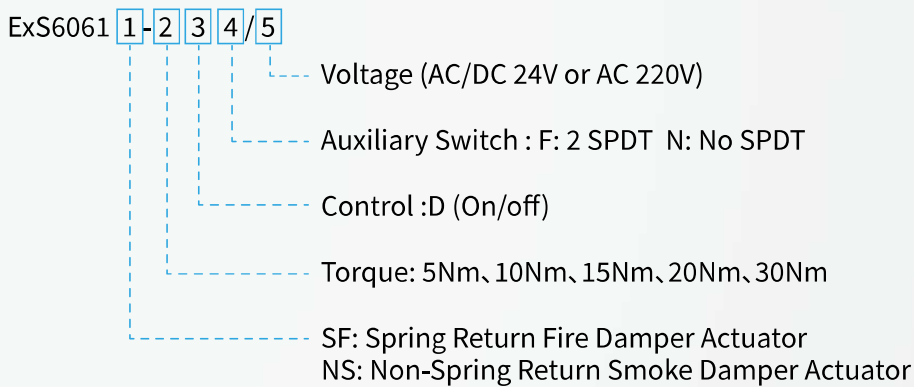
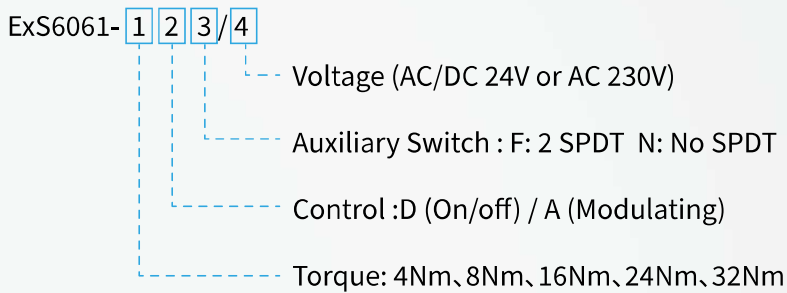
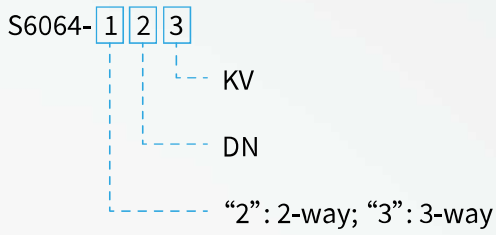

► Ball Valve and Actuator Configurations

Ball Valve Actuator	DN15~DN40	DN50	DN65、DN80	DN100、DN125
ExS6061 (Non-Spring Return)	ExS6061-04	ExS6061-08	ExS6061-16	ExS6061-24 ExS6061-32
ExS6061NS (Non-Spring Return)	ExS6061NS -10	ExS6061NS -10	ExS6061NS -20	ExS6061NS -30
ExS6061SF (Spring Return)	ExS6061SF -05	ExS6061SF -10	ExS6061SF -15	---

► Ball Valve Technical Specifications

Model	DN	(A-B) Way KV (m ³ /h)	Bypass KV (m ³ /h)	Angle of Rotation	Pressure Difference	2-Way (Kg)	3-Way (Kg)
S6064-2015A	15	1.3	1.6	0-90°	0.35Mpa	0.2	0.25
S6064-2015B		2.5	2.5				
S6064-2015C		3.6	4.0				
S6064-2015D		4.6	5.0				
S6064-2020A	20	2.3	2.5			0.35	0.4
S6064-2020B		4.5	4.0				
S6064-2020C		6.5	5.0				
S6064-2025A	25	9.5	6.3			0.55	0.7
S6064-2025B		23.5	8.0				
S6064-2032A	32	15	10.0			0.85	1.10
S6064-2032B		36	12.5				
S6064-2040A	40	24	16.0			1.2	1.4
S6064-2040B		36	20.0				
S6064-2050A	50	42	25.0			1.95	2.20
S6064-2050B		60	31.5				
S6064-2065A	65	43	---			4.5	---
S6064-2080A	80	77	---			6.8	---
S6064-2100A	100	108	---			8.1	---
S6064-2125A	125	204	---			12.0	---

► Direction of Flow

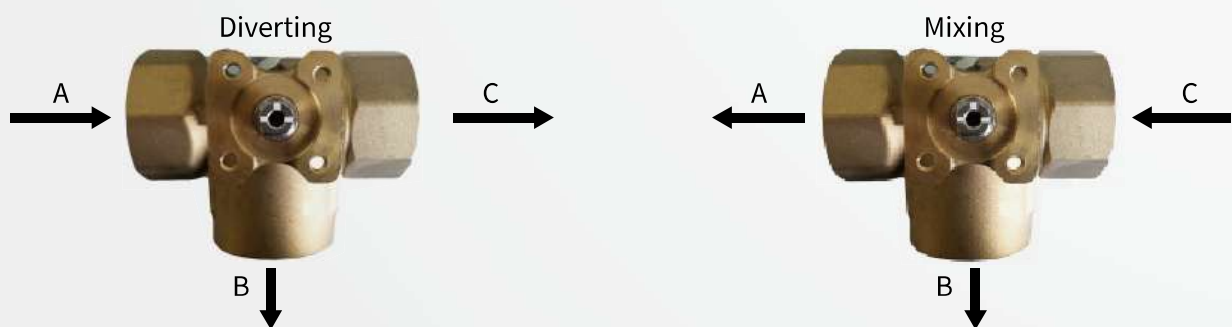

► **DN15-DN50 Ball Valve Dimensions unit (mm)**

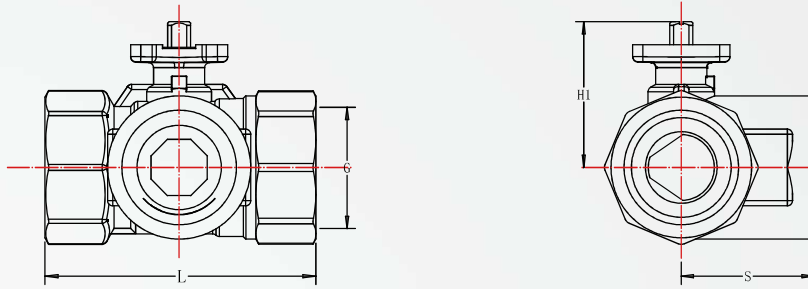

Model No.	G	H1(mm)	L(mm)	S(mm)
S6064-2015	G1/2	37.5	60	---
S6064-2020	G3/4	44	73	---
S6064-2025	G1	47	89	---
S6064-2032	G1-1/4	52.5	102.5	---
S6064-2040	G1-1/2	57	113	---
S6064-2050	G2	62	127.5	---
S6064-3015	G1/2	39	60	30.5
S6064-3020	G3/4	44	66	32
S6064-3025	G1	47	89	46.5
S6064-3032	G1-1/4	52.5	98.5	49
S6064-3040	G1-1/2	57	106	52
S6064-3050	G2	62	123	69

Note: DN15-50 use BSPP British standard parallel pipe thread connection.

► **DN65-DN125 Ball Valve Dimensions unit (mm)**

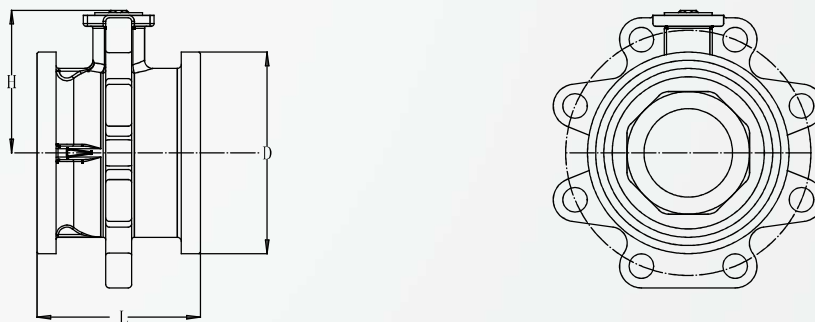

Model	Flange	L(mm)	D(mm)	H(mm)	n-d
S6064-2065	145	97	105	136	4-18
S6064-2080	160	108	125	140	8-18
S6064-2100	175	120	145	104	8-18
S6064-2125	200	145	175	115	8-18

Caution: To avoid injuries whilst the valve is closing, do not put fingers inside when the valve is open.

► Ball Valve Installation Diagrams

ExS6061

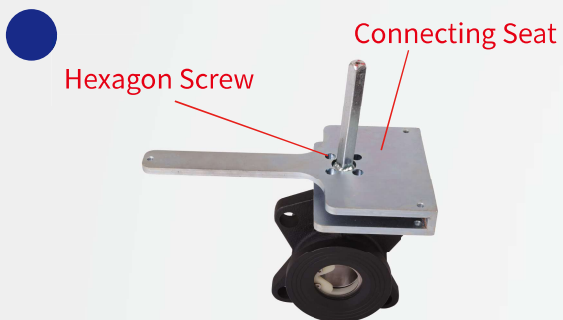

ExS6061SF/NS

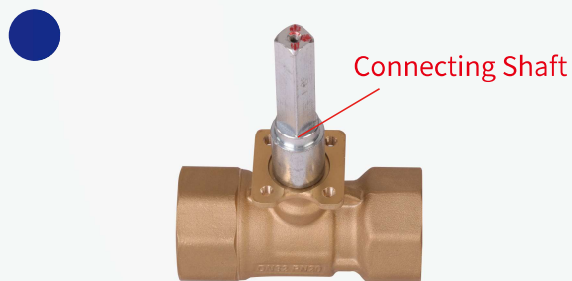

The installation must be carried out by personnel who have received relevant training or relevant work experience. During the installation process, be careful not to operate with power on, and install the actuator according to the regulations.